

Automatic venting

Item number 2520120001

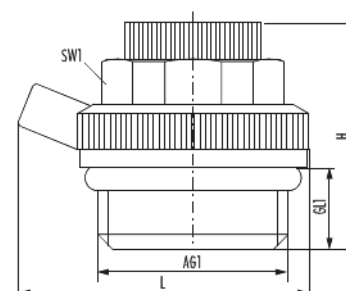

Technical data

Connection size 1 (AG1)	G 1/2
Connection type 1 (AT1)	External thread
Connection type 2 (AT2)	Venting
Outlet	Rotating
Operation	automatic bleeding
Thread Length 1 (GL1)	9 mm
Wrench size 1 (SW1)	19 mm
Length (L)	36 mm
Width (B)	36 mm
Height (H)	25 mm
Material moulded seal	EPDM
Material body/spindle	Nickel-plated brass
Material	Nickel-plated brass
Max. operating pressure	8.5 bar

Automatic venting

Item number 2520120001

Max. operating temperature heating 115 °C

Commercial data

Packaging Unit	100
EAN code	4033878101179
Weight	0.046 kg
ETIM 7	EC010047
ETIM 8	EC010047
eCl@ss 10.1	22-39-04-10
Customs tariff number	84818039

Note:

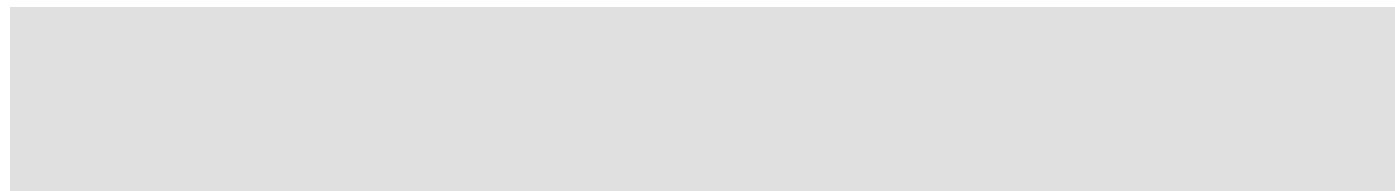

Automatic venting

Item number 2520120001